



Southern Cross
University

A new way to think

QRNO Mobility workshop

November 2011

Our users

- Increasingly mobile
- Estimated 20-25% of wireless network users connecting with mobile devices
- 10,000's web hits per month average from mobile device operating systems
- Growing fast



AAAAAccess

- Any where
- Any time
- Any place
- Any device



iPad Trial

- 135 iPads
- Students, Staff (Professional & Academic)
 - Hotels School
 - Library Loans
 - Nursing
 - Mixed/Demographic Spread
- Senior Exec
- Council Members
 - All Papers on an iPad



iPad Trial

- \$50 iTunes cards for staff
- \$30 iTunes cards for students
- Must load Docs To Go and iAnnotate
- BlackBoard sites setup (Students and Staff)
- Benchmarking Global activity
- Cheat sheets and Web Site developed



Some anecdotal feedback

The slide features several decorative stars of varying colors (light blue and yellow) scattered across the background.

- Most downloaded app
 - Facebook (Actually iBooks – FB was #2)
- Most useful app
 - Dropbox
- Very high expectations for functionality!

Related

- eReaders
 - Library Trial

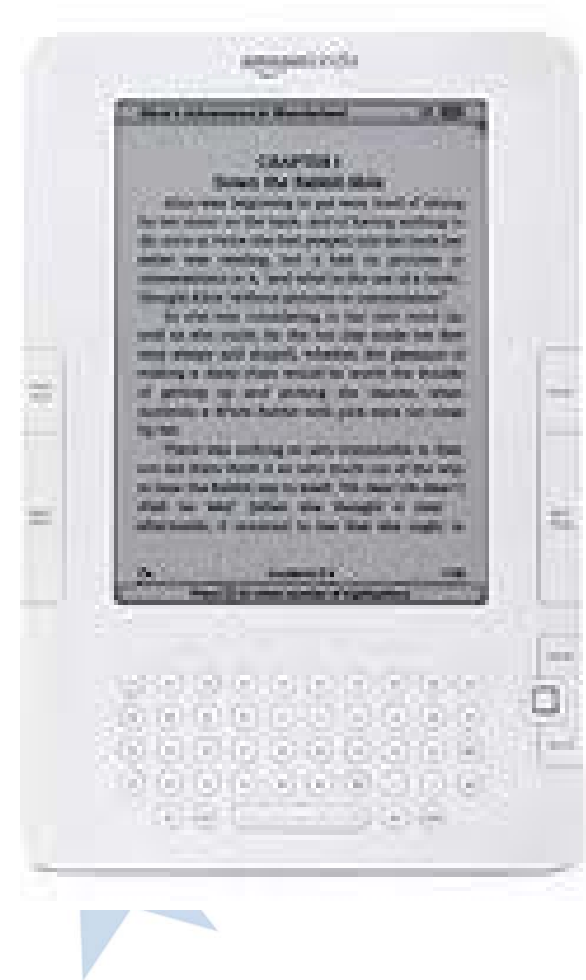

Wireless Changes

- Wireless Network support for mobile device connection (Smartphones, iPhones, iPads etc.) during Session 1&2, 2011
- Major upgrade to Lismore Campus network to bring wireless availability to the same levels as other campuses



Wireless Usage

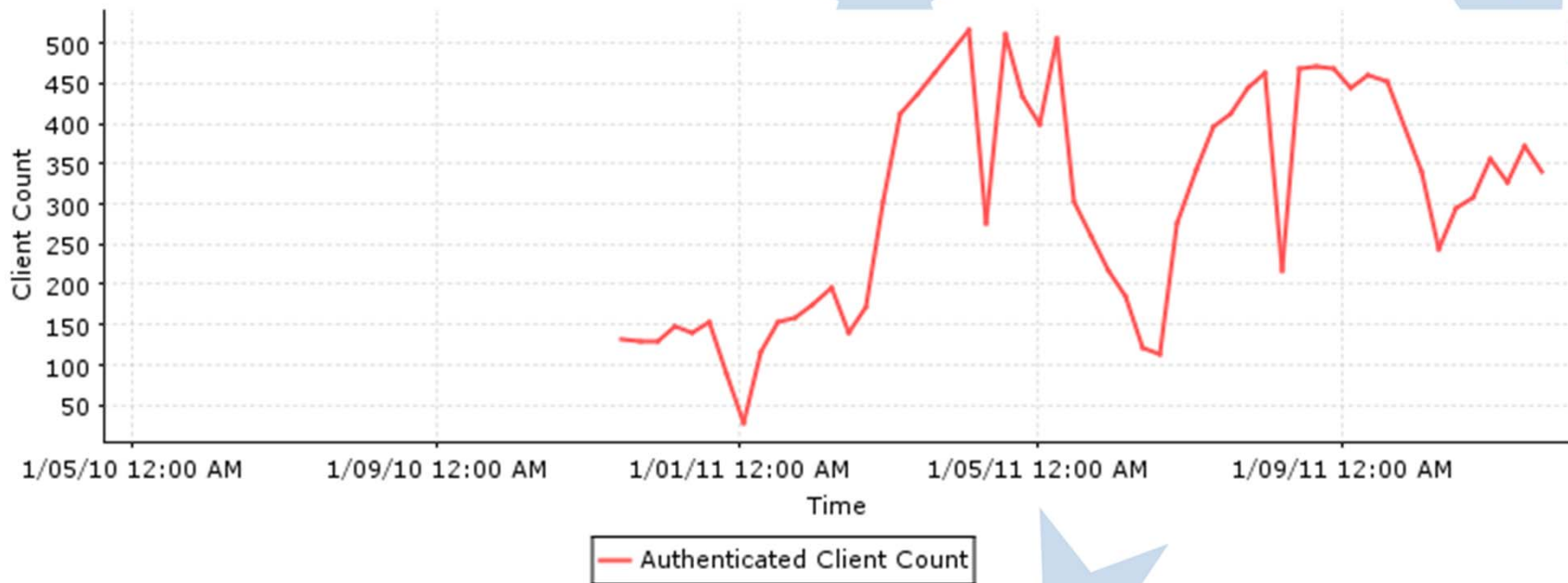

Lismore Wireless Coverage

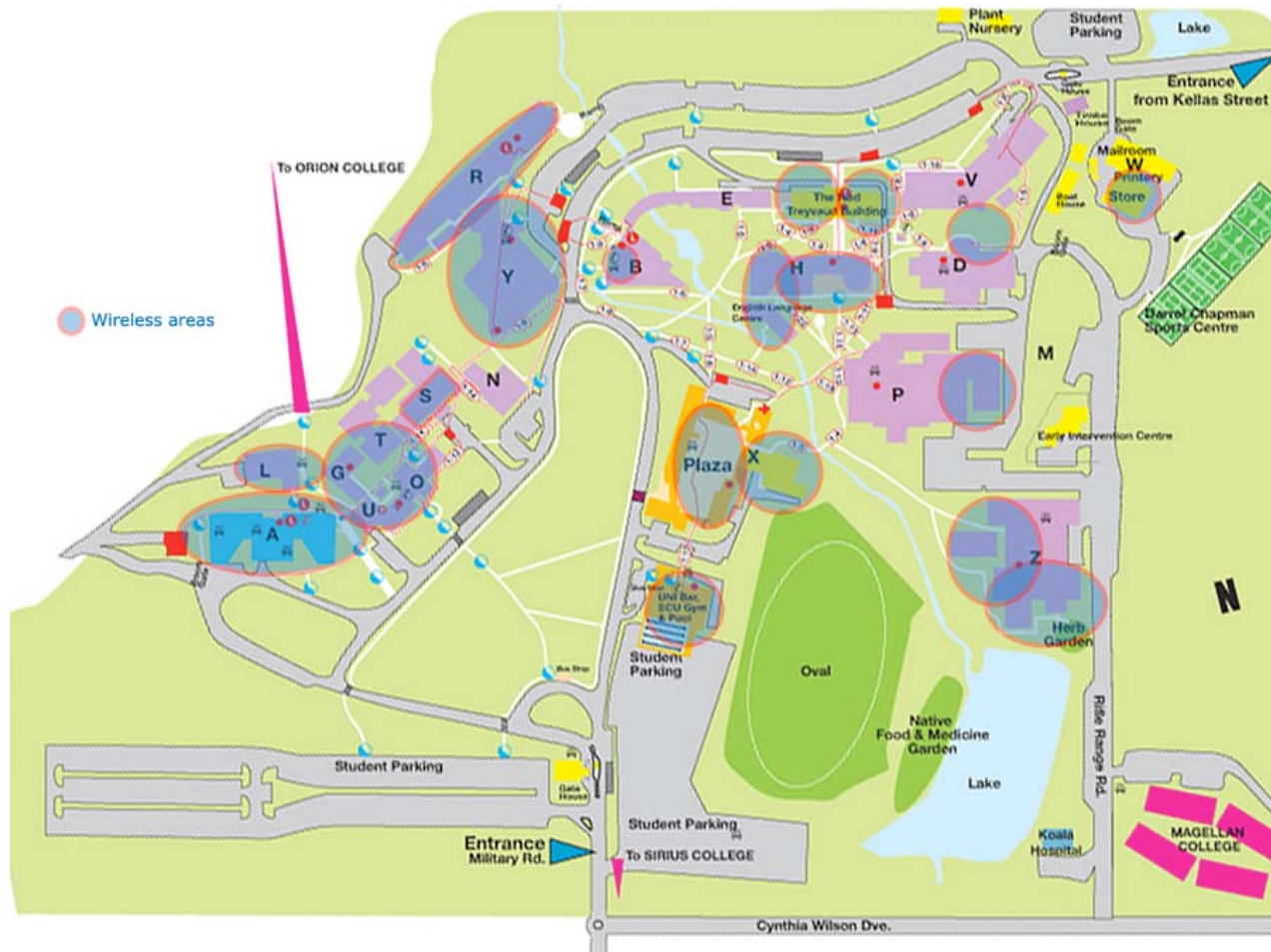

Mobile Apps

- Blackboard Mobile Learn
 - Live now
- Blackboard Mobile Central
 - In development



Other responses

- Quick Start Guides
- Usage Guidelines
 - E.g. lock device
 - Turn off data roaming, etc.
- Tethering
 - Reducing demand for modems
- Email/calendars, etc.
 - Notifier Link - SaaS

Challenges

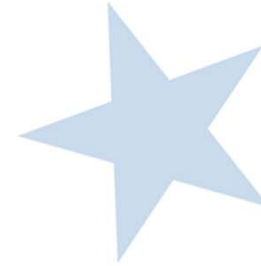

- Data Plans
- Support
 - Diversity of devices
 - Training



Data Plans					
Included Allowance ¹	Casual Plan	Standard Plan	Member Plan ²	Mobile Voice Data Pack ³	Excess usage Charges ⁴
5 MB	\$5	N/A	N/A	N/A	\$1.00
150MB	\$10	N/A	N/A	N/A	50c
300MB	\$29	N/A	N/A	N/A	25c
1GB	\$39	\$29	\$29	\$19	25c
3GB	\$49	\$39	\$29	\$29	15c
6GB	\$79	\$69	\$59	\$59	10c
9GB	\$99	\$89	\$79	\$79	5c
20GB	\$169	\$159	\$149	\$149	5c
50GB	\$360	\$360	N/A	N/A	5c
70GB	\$480	\$480	N/A	N/A	5c
90GB	\$560	\$560	N/A	N/A	5c
120GB	\$600	\$600	N/A	N/A	5c



Challenges

- Data Storage
 - DropBox?
- Security
- Diversity
- Finding the right uses!
- App Management
 - Which apps?
 - How to license



Future

- BYOD (it's already the reality)
- Increase corporate applications support
 - Tablets
 - small format screens
 - Virtualisation?
- Mobile aware web sites
- Ummm.....

QUESTIONS